



National Service Department  
 500 Bond St.  
 Lincolnshire, IL. 60069  
 847/541-4477

# NATIONAL SERVICE BULLETIN

TO: SEE DISTRIBUTION

N.S.B. NO: 185E

FROM: NATIONAL SERVICE

Page  1  of  1

SUBJECT: **CI-12 / CI-12-2 SERVICE MANUAL UPDATE** Date: 08/26/99

This N.S.B. obsolete's N.S.B . 185A dated 10/18/96 and N.S.B. 185C dated 01/27/99.

Here are revised part numbers for the Model CI-12 / CI-12-2 Color Coil Inserter. Model CI-12-2 is the same as the Model CI-12 except it does not have the crimper/cutters. Instead, a hand held Color Coil Pliers are used. Customers can order replacement Color Coil Pliers from National Service.

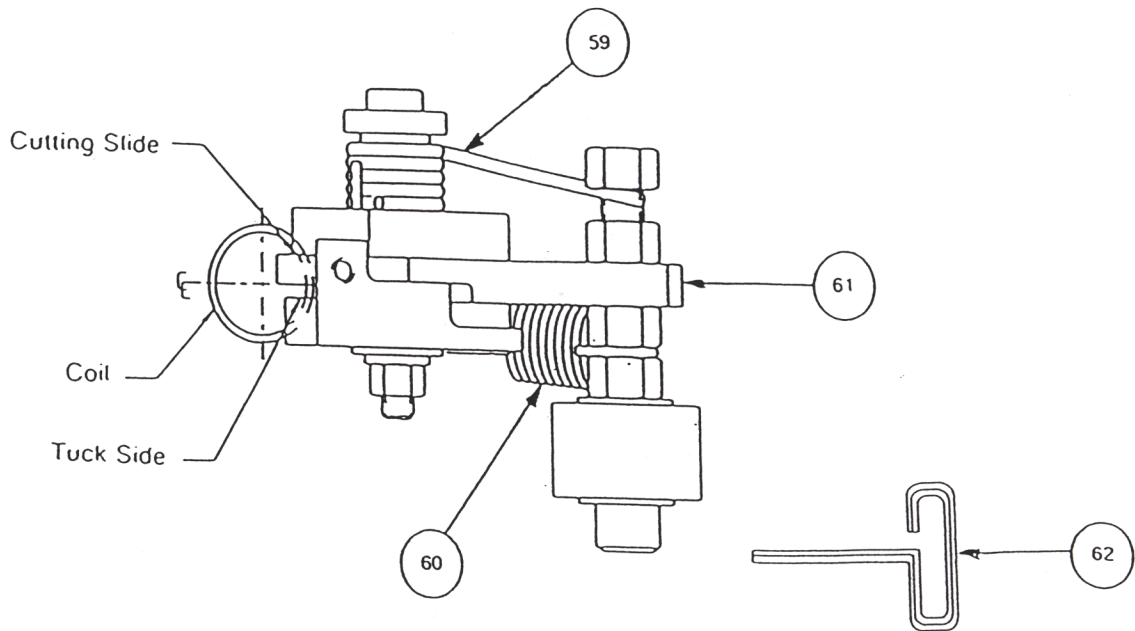

SICKENGER			
ITEM NO.	PART NO.	DESCRIPTION	QTY
59	0320108200	L.H. Compression Spring	1
59	0320108700	R.H. Compression Spring	1
60	0750044300	Extension Spring	2
61	0320107100	Small L.H. Cutter Assy (Black)	1
	0320107400	Small R.H. Cutter Assy (Black)	1
	0320107300	Large R.H. Cutter Assy (Silver)	1
	0320107200	Large L.H. Cutter Assy (Silver)	1
62	0751106700	T-Handle 3/16"	1
	0670067000	Color Coil Pliers ( CI-12-2) Not Shown	1

# CI-12

## 7.0 PARTS LIST

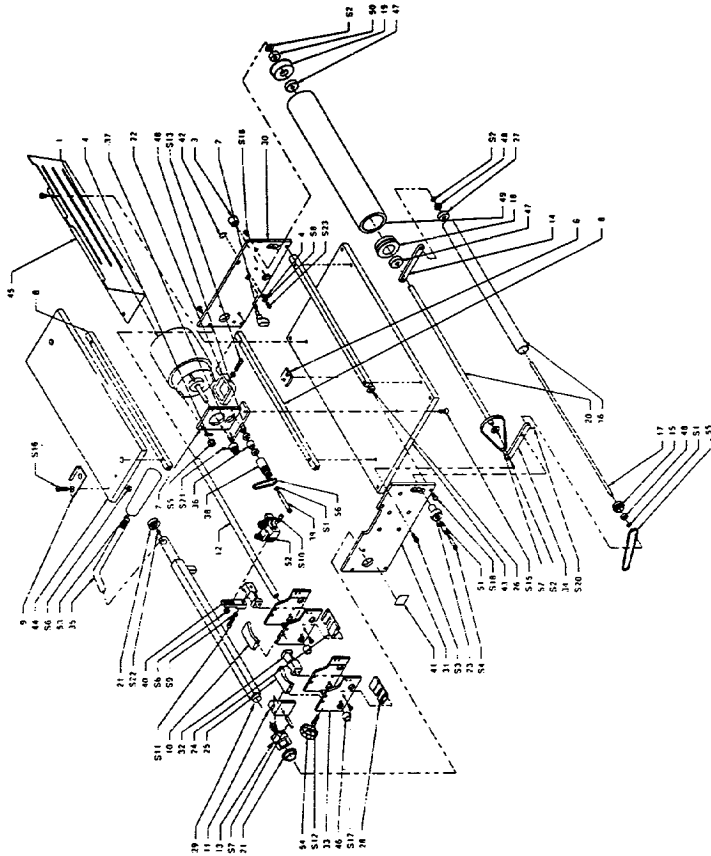

Figure 7-1  
7-2

## 7.0 PARTS LIST

ITEM NO.	OLD PART NO.	NEW PART NO.	DESCRIPTION	QTY.
1	0220007500	1770730	1/15 HP Motor	1
2	0220017100	1770731	Toggle Switch	1
3	0220131000	1770732	Strain Relief Cord	1
4	0220172000	1770733	Stak-On	3
5	0220175500	1770734	Butt Splice (Not Shown)	2
6	0220223500	1770735	Adhesive Base	1
7	0321000300	1770736	Motor Bracket	1
8	0321000600	1770737	Support Bar	2
9	0321001000	1770738	Guide - Side	1
10	0321001200	1770739	Guide - Top - Right	1
11	0321001700	1770742	Slide	2
12	0321001800	1770743	Bar - Guide	2
13	0321002000	1770744	Linkage	2
14	0321002100	1770745	Bracket - Pivot - Right	1
15	0321002200	1770746	Pulley - Small Roller	1
16	0321002300	1770747	Roller - Small	1
17	0321002400	1770748	Axle - 1/4" Diameter	1
18	0321002500	1770749	Pulley - Large Roller	1
19	0321002600	1770752	End Cap	1
20	0321002700	1770753	Axle - 3/8" Diameter	1
21	0321002900	1770754	Flange Bushing - Modified	2
22	0321003000	1770755	Stop	1
23	0321003200	1770756	Knob - Pull	2
24	0321003400	1770757	Guide - Bottom - Right	1
25	0321004000	1770758	Guide - Top - Left	1
26	0321004500	1770759	Support Bar - Notched	1
27	0321005900	1770762	End Cap	1
28	0321006300	1770763	Guide - Bottom - Left	1
29	0321007700	1770764	Shaft - Square	1
30	0321007800	1770765	Side Plate - R.H.	1
31	0321007900	1770766	Side Plate - L.H.	1
32	0321008000	1770767	Tool Holder	2
33	0321008600	1770768	Tool Support	2

## 7.0 PARTS LIST

ITEM NO.	OLD PART NO.	NEW PART NO.	DESCRIPTION	QTY.
34	0321008800	1770769	Bracket - Pivot - Left	1
35	0321008900	1770772	Handle	1
36	0321009000	1770773	Spacer	1
37	0321009100	1770774	Pulley - Motor	1
38	0321009200	1770775	Pulley - Jack Shaft	1
39	0321009300	1770776	Shoulder Screw - Modified	1
40	0321009700	1770777	Tool Post	2
41	0480002500	1770778	Tag - Serial	1
42	0480016500	1770779	Tag - On/Off	1
43	0480036200	1770782	Base	1
44	0480036400	1770783	Shelf - Top	1
45	0480036600	1770784	Guard - Louvered	1
46	0485000200	1770785	Bearing - Bronze	8
47	0485057000	1770786	Bearing - Ball	2
48	0485086700	1770787	Bearing - Ball	4
49	0487072700	1770788	Rolier - Large	1
50	0750001000	1770789	Clamp Collar - 3/8" I.D	2
51	0750030200	1770792	Spring - Compression	2
52	0750044300	1770793	Spring - Extension	2
53	0750081000	1770794	Handle - Tapered	1
54	0750094000	1770795	Knob	2
55	0750100300	1770796	O-Ring - Small Roller	1
56	0750100400	1770797	O-Ring - Jackshaft	2
57	0750109600	1770798	O-Ring - Large Roller	1
58	0750180000	1770799	Bumper (Not Shown)	4

## 7.0 PARTS LIST

### STANDARD HARDWARE PARTS LIST

ITEM NO.	OLD PART NO.	NEW PART NO.	DESCRIPTION	QTY.
S1	0750194200		Thrust Washer	4
S2	0750196700		Thrust Washer	2
S3	0750230200		Screw - Shoulder, 1/4 X 1/4	2
S4	0750231500		Screw - Shoulder 1/4 X 1	2
S5	0750301100		Nut - KEP, 8-32	5
S6	0750304000		Nut - Hex, 1/4-20	6
S7	0750369200		Roll Pin, 1/4 Diameter X 1-1/4	2
S8	0750404100		External Tooth Washer, #8	1
S9	0750411000		Washer - Lock, 1/4	4
S10	0750719000		SHCS, 1/4-20 X 1/2	2
S11	0750720000		SHCS, 1/4-20 X 3/4	4
S12	0750721500		SHCS, 1/4-20 X 3/4 (Bronze)	2
S13	0750722000		SHCS, 1/4-20 X 1	2
S14	0750734500		SHCS, 3/8-16 X 1/2	1
S15	0750864500		FHCS, 3/8-16 X 1/2	6
S16	0750865000		FHCS, 1/4-20 X 1	1
S17	0750935000		BHCS, 10-24 X 3/8	24
S18	0750940000		BHCS, 1/4-20 X 3/8	2
S19	0750941000		BHCS, 1/4-20 X 1/2	13
S20	0751007000		SSS, 6-32 X 1/8	2
S21	0751014000		SSS, 8-32 X 1/4	1
S22	0751024000		SSS, 1/4-20 X 1/4	1
S23	0753393600		Screw - Pan Head, 8-32 X 1	1