



# 960X PARTS LIST

Revised 04/18/06



GBC IS AN ACCO BRANDS COMPANY

# 960X HEAD ASSY

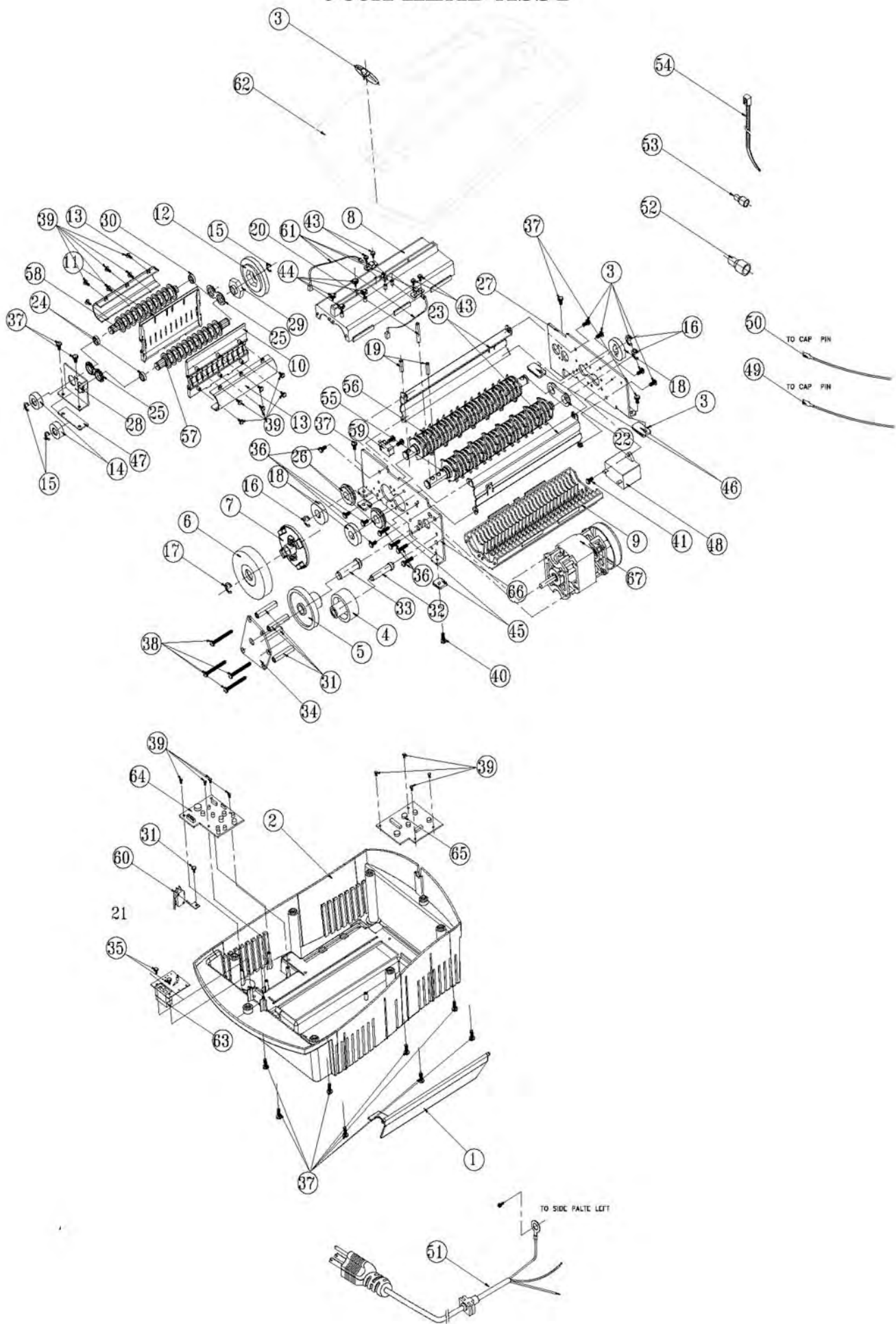

## 960X PARTS LIST

67	6600000199X	AC 82MM 115V	1
66	13042570010X	900 SIDE PLATE A	1
65	91020003000X	GBC 900 POWER PCB ASS'Y	1
64	91020003016X	GBC 955S MIR PCB ASS'Y	1
63	91020002943X	GBC 950S LED ASS'Y	1
62	91000010978X	960X TOP COVER ASS'Y	1
61	91000012449X	900 SERIS AUTO EYE ASS'Y	1
60	91000011068X	GBC 950S/955X SAFETY ASS'Y	1
59	91000011007X	GBC 2250S BIN FULL ASS'Y	1
58	91000010973X	960X CD SHAFT B ASS'Y	1
57	91000010972X	960X CD SHAFT A ASS'Y	1
56	91000010971X	955X-1 SHAFT B ASS'Y	1
55	91000010969X	955X-1 SHAFT A ASS'Y	1
54	710100006100	CABLE TIE L=120MM	8
53	690300006400	CNT POWER	3
52	690300005700	CNT POWER	4
51	640100076900	CABLE POWER 3PIN	1
50	630152300434	LW UL1015#20 00 240MM	1
49	630152000433	LW UL1015#20 60 250MM	1
48	564206612010	PLS-DIP CAP 20uF 250V	1
47	18020000757X	960X CD BRACKET RUBBER G	1
46	18020000756X	950X & 955X PLATE RUBBER B	2
45	18020000755X	950X & 955X PLATE RUBBER A	2
44	155300811111	B-T/SCREW M3 8MM WASHER	4
43	155300811110	B-T/SCREW M3 8MM	4
42	153501657110	P-T/SCREW M5 16MM	12
41	152401017114	C-M/SCREW M4 10MM	1
40	151501031110	M/SCREW M5 10MM	1
39	152300627110	SCREW C-M/SCREW #3 6MM	20
38	151505037110	SCREW M5 50MM	4
37	151501611110	M/SCREW M5 16MM	12
36	151501017111	M/SCREW M5 10MM	12
35	151301411110	M/SCREW M3 14MM	2
34	13042730010X	950S GEAR COVER	1
33	13042700010X	GEAR SHAFT B	1
32	13042690010X	GEAR SHAFT A	1
31	13042670010X	GEAR SUPPORT	4
30	13042610010X	CD BUSHING	1
29	13042600010X	GEAR BUSHING	1
28	13042590010X	960X CD BRACKET	1
27	13042580010X	900 SIDE PLATE B	1
26	13042300010X	6002 BEARING	2
25	13015510010X	BUSHING A	2
24	13014700010X	BUSHING B	2
23	13012470010X	SUPPORT PLATE	2
22	13007460010X	BUSHING	1
21	13007130010X	SWITCH FIXER	1
20	13007130010X	KNIFE SHAFT PIN	1
19	13006090010X	KNIFE SHAFT PIN	2
18	13005960010X	SPUPGEAR 20T	3
17	13002750010X	E RING	1
16	130026600100	#12 E RING	3
15	130026500100	#9 E RING	3
14	13002090010X	GEAR	2
13	1008150010X	KNIFE COVER CD	2
12	10081070020X	38T CD GEAR	1
11	10080810010X	PAPER GUIDE B CD	1
10	10080800010X	PAPER GUIDE A CD	1
09	10080790010X	PAPER GUIDE B	1
08	10080780010X	PAPER GUIDE A	1
07	10070820020X	GEAR SUPPORT	1
06	10070810010X	GEAR-C	1
05	10070800020X	GEAR-B	1
04	10070790020X	GEAR-A	1
03	10032690010X	BUTTON	1
02	10032663010X	BOTTOM COVER	1
01	10006070020X	FALP	1
ITEM	PART NO.	DESCRIPTION	Q'TY